

GSMD52305

20V P-Channel MOSFETs

Product Description

These P-Channel enhancement mode power field effect transistors are using trench DMOS technology. This advanced technology has been especially tailored to minimize on-state resistance, provide superior switching performance, and withstand high energy pulse in the avalanche and commutation mode.

These devices are well suited for high efficiency fast switching applications.

Features

- -20V, -11A, $R_{DS(ON)}=16m\Omega@V_{GS}=-4.5V$
- Improved dv/dt capability
- Fast switching
- Suit for -1.8V Gate Drive Applications
- Green Device Available
- SOP-8 package design

Applications

- Notebook
- Load Switch
- Networking

Packages & Pin Assignments

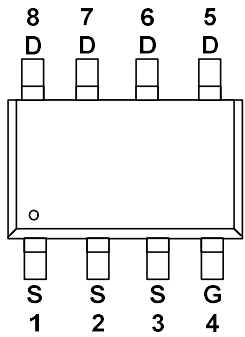
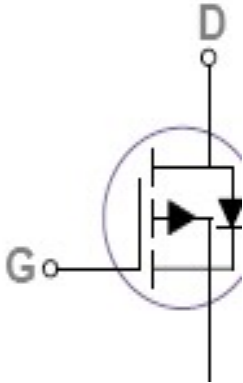
GSMD52305SF (SOP-8)			
			
			
Pin	Description	Pin	Description
1	Source	5	Drain
2	Source	6	Drain
3	Source	7	Drain
4	Gate	8	Drain

Ordering Information

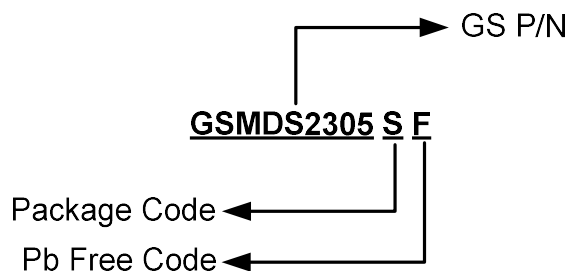

Part Number	Package	Quantity Reel
GSMD S2305 S F	SOP-8	4000 PCS

Marking Information

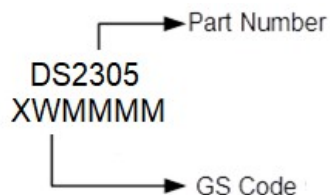

Absolute Maximum Ratings

$T_A=25^{\circ}\text{C}$ Unless otherwise noted

Symbol	Parameter	Typical	Unit
V_{DS}	Drain-Source Voltage	-20	V
V_{GS}	Gate-Source Voltage	± 10	V
I_D	Continuous Drain Current	$T_A=25^{\circ}\text{C}$	-11
		$T_A=100^{\circ}\text{C}$	-7
I_{DM}	Pulsed Drain Current	-44	A
P_D	Power Dissipation ($T_A=25^{\circ}\text{C}$)	2.5	W
	Power Dissipation (Derate above 25°C)	0.02	$\text{W}/^{\circ}\text{C}$
T_J	Operating Junction Temperature Range	-55 to +150	$^{\circ}\text{C}$
T_{STG}	Storage Temperature Range	-55 to +150	$^{\circ}\text{C}$
$R_{\theta JA}$	Thermal Resistance-Junction to Ambient	50	$^{\circ}\text{C}/\text{W}$

Electrical Characteristics

T_A=25°C Unless otherwise noted

Symbol	Parameter	Conditions	Min	Typ	Max	Unit
Static						
V _{(BR)DSS}	Drain-Source Breakdown Voltage	V _{GS} =0V, I _D =-250uA	-20			V
ΔBV _{DSS} /ΔT _J	BV _{DSS} Temperature Coefficient	Reference to 25°C, I _D =-1mA		-0.01		V/°C
V _{GS(th)}	Gate Threshold Voltage		-0.3	-0.6	-1.0	V
ΔV _{GS(th)}	V _{GS(th)} Temperature Coefficient	V _{DS} =V _{GS} , I _D =-250uA		3		mV/°C
I _{GSS}	Gate Leakage Current	V _{DS} =0V, V _{GS} =±10V			±100	nA
I _{DSS}	Zero Gate Voltage Drain Current	V _{DS} =-20V, V _{GS} =0V			-1	uA
		V _{DS} =-16V, V _{GS} =0V, T _J =125°C			-10	
I _S	Continuous Source Current	V _G =V _D =0V, Force Current			-11	A
I _{SM}	Pulsed Source Current				-44	
R _{DS(on)}	Drain-Source On-Resistance	V _{GS} =-4.5V, I _D =-6A		12	16	mΩ
		V _{GS} =-2.5V, I _D =-4A		16	22	
		V _{GS} =-1.8V, I _D =-3A		21	28	
g _{FS}	Forward Transconductance	V _{DS} =-10V, I _D =-6A		20		S
V _{SD}	Diode Forward Voltage	V _{GS} =0V, I _S =-1A			-1	V
Dynamic						
Q _g	Total Gate Charge	V _{DS} =-10V, V _{GS} =-4.5V, I _D =-6A		27	40	nC
Q _{gs}	Gate-Source Charge			2.4	4.8	
Q _{gd}	Gate-Drain Charge			5.3	8	
C _{iss}	Input Capacitance	V _{DS} =-15V, V _{GS} =0V, f=1MHz		2320	3370	pF
C _{oss}	Output Capacitance			280	410	
C _{rss}	Reverse Transfer Capacitance			175	260	
t _{d(on)}	Turn-On Time	V _{DD} =-10V, I _D =-1A, V _{GS} =-4.5V, R _G =25Ω		16.2	31	ns
t _r				43.5	83	
t _{d(off)}	Turn-Off Time			114	217	
t _f				28.8	55	

Typical Performance Characteristics

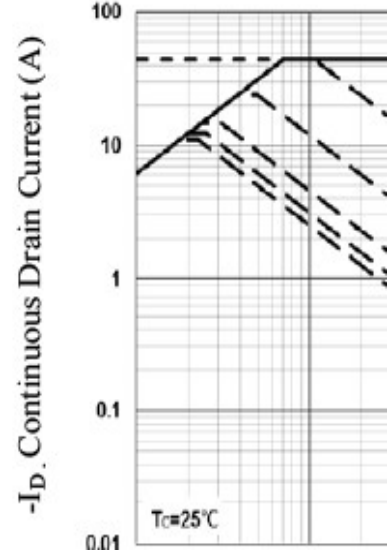
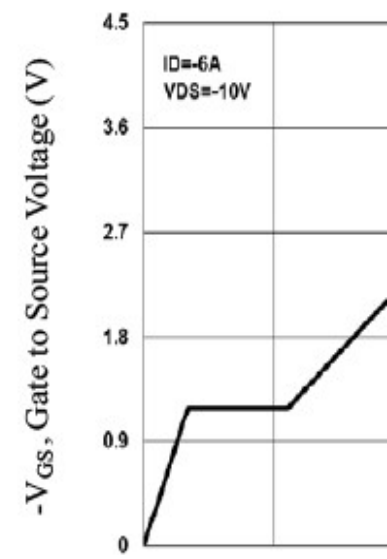
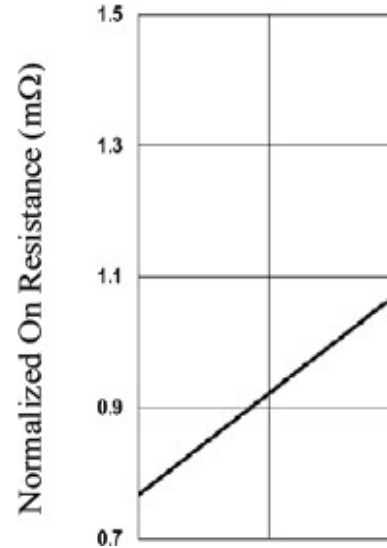
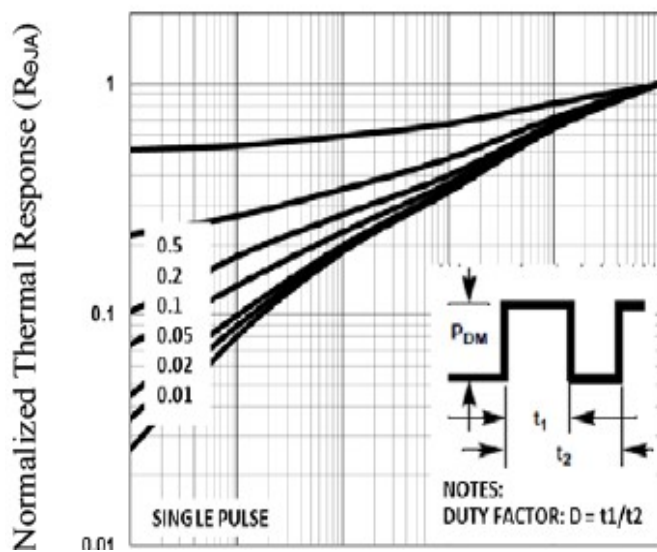
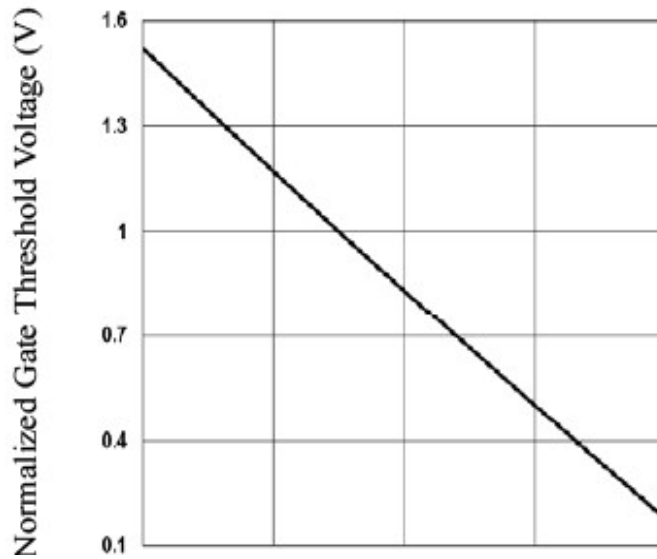
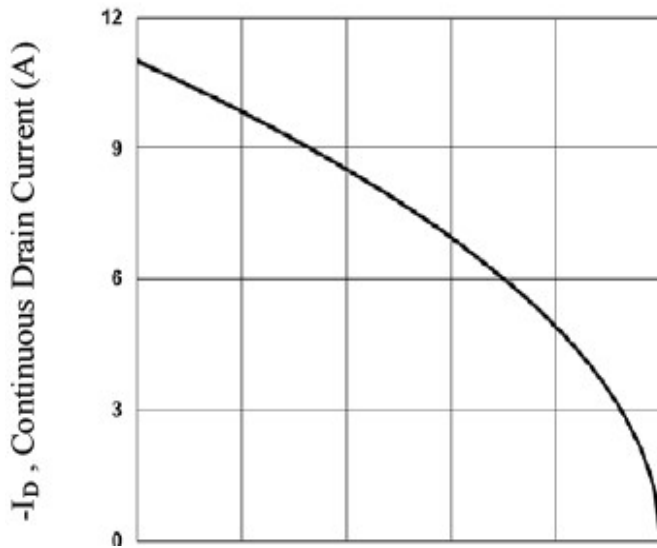

Typical Performance Characteristics (Continue)

Gate Charge Test Circuit & Waveform

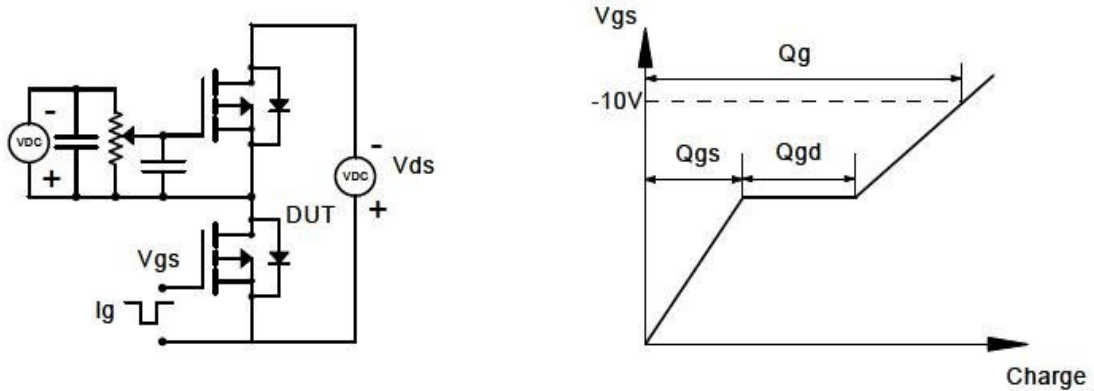

Resistive Switching Test Circuit & Waveforms

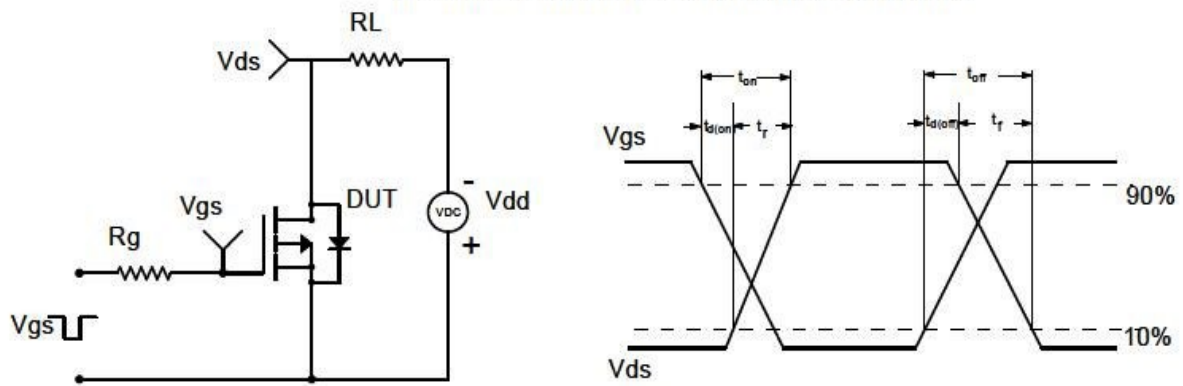

Diode Recovery Test Circuit & Waveforms

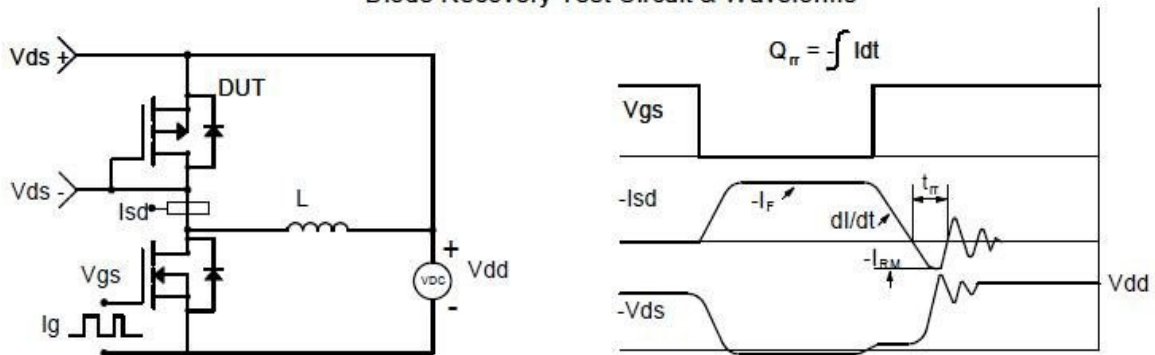

Package Dimension

SOP-8

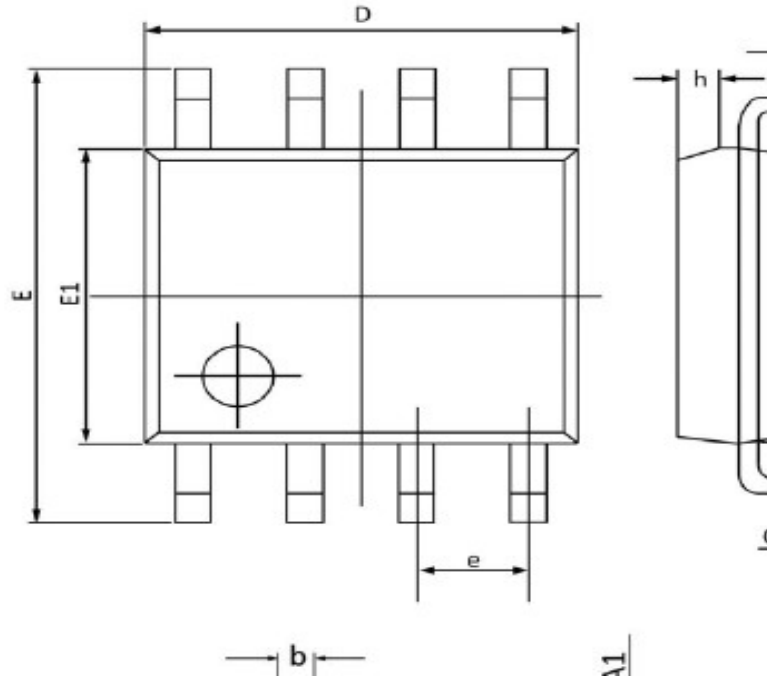







Dimensions				
Symbol	Millimeters		Inches	
	Min	Max	Min	Max
A	1.350	1.750	0.053	0.068
A1	0.100	0.250	0.004	0.009
A2	1.300	1.500	0.052	0.059
A3	0.600	0.700	0.024	0.027
b	0.390	0.480	0.016	0.018
c	0.210	0.260	0.009	0.010
D	4.700	5.100	0.186	0.200
E	5.800	6.200	0.229	0.244
E1	3.700	4.100	0.146	0.161
e	1.270 (BSC)		0.050 (BSC)	
h	0.250	0.500	0.010	0.019
L	0.500	0.800	0.019	0.031
L1	1.050 (BSC)		0.041 (BSC)	
θ	0°	8°	0°	8°

NOTICE

Information furnished is believed to be accurate and reliable. However Globaltech Semiconductor assumes no responsibility for the consequences of use of such information nor for any infringement of patents or other rights of third parties, which may result from its use. No license is granted by implication or otherwise under any patent or patent rights of Globaltech Semiconductor. Specifications mentioned in this publication are subject to change without notice. This publication supersedes and replaces all information without express written approval of Globaltech Semiconductor.

CONTACT US

GS Headquarter	
	4F.,No.43-1,Lane11,Sec.6,Minquan E.Rd Neihu District Taipei City 114, Taiwan (R.O.C)
	886-2-2657-9980
	886-2-2657-3630
	sales_twn@gs-power.com

RD Division	
	824 Bolton Drive Milpitas. CA. 95035
	1-408-457-0587